



RUTGERS

The Rutgers University Libraries
c/o Archibald S. Alexander Library
Rutgers, The State University of New Jersey
169 College Avenue
New Brunswick, NJ 08901-1163

IN THIS ISSUE

- The place to go, when you need to use a computer
- New Reference Desk in Alexander Library
- New furniture in the John Cotton Dana Library
- New resources in the Libraries
- Two Milton exhibitions at Alexander Library

RUTGERS
University Libraries

Report

SPRING 2011 ISSUE

THE PLACE TO GO, WHEN YOU NEED TO USE A COMPUTER

It might surprise many people to learn which Rutgers University facility will soon have the most computers available for student use.

Is it a computer lab on Busch?

Or is it a large classroom building in Newark?

No.

It will be the Paul Robeson Library on the Rutgers-Camden campus.

As part of an ongoing whole-scale renovation project, the library has installed state of the art motorized compact shelving units on the lower level and moved a large portion of their book collections into those shelves. Touch screen computers aid users in locating items.

Using the now-cleared prime real estate on their first floor, the library partnered with the Office of Information Technology-Camden Computing Services to merge all

public computing labs on the Camden campus into one large lab in the library. The combined OIT and library computer labs will feature over 180 computers for student use, which includes 160 or more OIT-supported computers and 25 Libraries-supported computers.

An added value of the OIT/library computer labs will be the availability of a librarian on premises during regular business hours to assist students in developing their research projects effectively and locating the materials they need to successfully complete their work. OIT staff will also be nearby to address any concerns about computer access, computer applications, and routine

computer support.

The new OIT/library computer lab should be completed by the beginning of the fall 2011 semester.

Paul Robeson Library Director, Gary Golden, has already observed an increase in



reference contacts between librarians and students in the library, which he attributes to the increased number of computers attracting more students. The rise in reference contacts point to what is, perhaps, the greatest potential of the new OIT/library partnership - to increase students' use of librarians' expertise, helping them to identify and successfully use university-level information resources.

NEW REFERENCE DESK IN ALEXANDER LIBRARY



Related stories/links:

- **Laptop loan program, in the Art Library**
http://www.libraries.rutgers.edu/rul/news/10/08_laptop_lending.shtml
- **New PC availability webpage**
http://www.libraries.rutgers.edu/rul/pc_availability/pc_availability.shtml

COMING FALL 2011 – THE ‘SCARLET LATTE’ CAFE, IN ALEXANDER LIBRARY

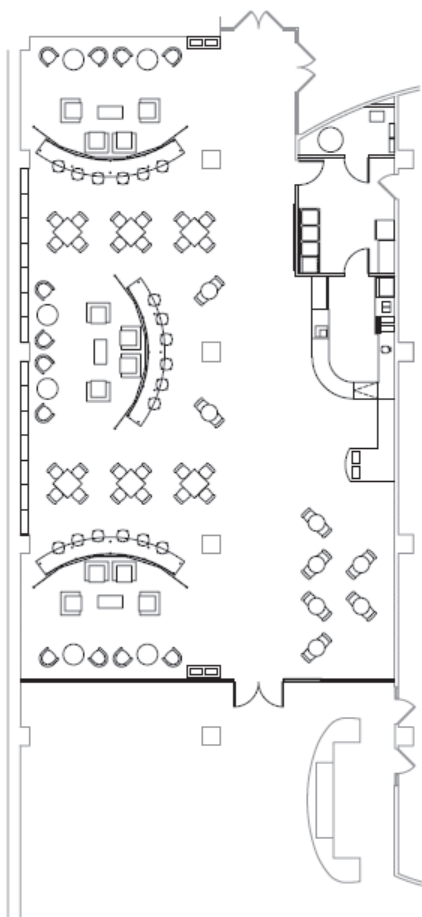

An architect's rendering of the new cafe.

NEW RESOURCES IN THE LIBRARIES

Chronicling America: Historic American Newspapers

Chronicling America is a searchable full-text collection of pages from more than 400 digitized newspapers from 23 states: Arizona, California, District of Columbia, Florida, Hawaii, Illinois, Kansas, Kentucky, Louisiana, Minnesota, Missouri, Montana, Nebraska, New York, Ohio, Oklahoma, Oregon, Pennsylvania, South Carolina, Texas, Utah, Virginia, and Washington. Coverage ranges from 1860 to 1922, but varies for each newspaper. Content for additional time periods and from all states and territories will eventually be included. Searches may be limited by state, newspaper, or date.

The database also includes a separately searchable newspaper directory which provides information about American newspapers published from 1690 to the present. Directory searches may be limited by place of publication, date, keyword, frequency, language, and type of newspaper.

Orchestral Music Online

Orchestral Music Online is the most recent iteration of David Daniels's classic repertoire reference work used by conductors, orchestras, musicians, and musicologists throughout the world. This new online version, based on the critically acclaimed fourth edition of the printed reference work *Orchestral Music: A Handbook* (2005, Scarecrow Press), provides greater and easier access to more information on composers and works.

Orchestral Music Online provides:

- Access to information on more than 7,000 works by nearly 1,000 composers
- Quick search by composer, title, or keyword
- Browsing by composer
- Advanced search by duration, instrumentation, chorus type, and soloists
- Ability to cut and paste data into rehearsal schedules and other documents to save time and to eliminate transcription errors
- Monthly updates with new composers, new works, additional information, and corrections
- More than 1,000 changes since publication of the 4th print edition
- Links from individual works to music publishers and other sources.

TWO MILTON EXHIBITIONS AT ALEXANDER LIBRARY

The spring exhibition in the Alexander Library, *Milton and the Cultures of Print*, is on display in the Special Collections and University Archives Galleries until May 31st. A new companion exhibition, *An Afterlife: The Literary and Cultural Influence of John Milton*, runs through July 1st.

Curated by Thomas Fulton, associate professor of English, both exhibits focus on 17th century poet and polemicist John Milton as an historical figure, placing him in the context of the turbulent times in which he lived and tracing his influence on authors and writers in the generations that followed.

The Rutgers University Libraries

hold the fifth largest collection of Milton's works at a public university in the United States. The collection was developed in the mid-twentieth century by Joseph Milton French, professor of English at Rutgers from 1940 to 1960 and esteemed Milton scholar. Highlights of the collection include first editions of Milton prose works *Areopagitica*, *Pro Populo Anglicano*, his three pamphlets on divorce, and many editions of Milton's poetry, including a copy of *Paradise Lost* illustrated by William Blake - all of which are on display.

For more information on the two exhibitions, contact Special Collections exhibitions coordinator Fernanda



William Marshall's image of Charles praying from *Elkon Basilike* (1649).

Perrone at hperrone@rulmail.rutgers.edu or 732.932.7006, ex. 363.

NEW FURNITURE IN THE DANA LIBRARY ON THE RUTGERS-NEWARK CAMPUS



The Report is a semi-annual publication from the Office of the Vice President for Information Services and University Librarian.

Marianne I. Gaunt, Publisher
Harry Glazer, Editor

Rutgers University Libraries
732/932-7505 • Fax 732/932-7636
Internet: www.libraries.rutgers.edu
Email: hglazer@rci.rutgers.edu